

Francis Lally

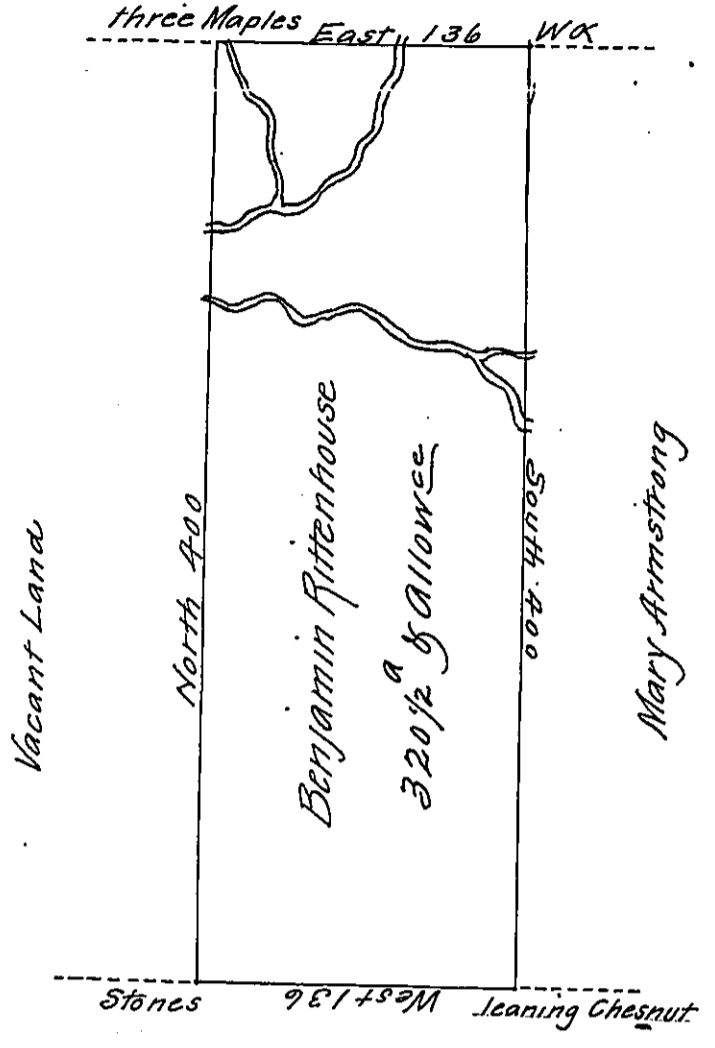

Surveyd to Benjamin Rittenhouse on the 17th Day of October 1774
 The above Described Tract of Three hundred & Twenty Acres & an half
 of an Acre & the Usual Allowance of Six p Ct. Situate on the East Branch
 of Kawanshanock adjoining Land granted to John Lewis in
 Westmorland County, By Warrant of the 22^d Day of June 1774
 p Joshua Elder D.S.
 To John Lukens Esq. S. Genl

IN TESTIMONY that the above is a copy of the original remaining on file in
 the Department of Internal Affairs of Pennsylvania, made
 conformably to an Act of Assembly approved the 16th day of
 February, 1833, I have hereunto set my Hand and caused
 the Seal of said Department to be affixed at Harrisburg,
 this Twenty first day of July 1910

Nancy Howell
 Secretary of Internal Affairs.